

# RVC-L C

Art.-Nr. 12000



- 1) Rokamat RVC-L C (22RSACCU0160)
- 2) 2014/30/EU, 2006/42/EG, 2012/19/EU, 2011/65/EU, 2001/95/EG, EG No. 1907/2006
- 3) EN 60335-1:2012 + AC:2014 + A11:2014 + A13:2017 + A1:2019 + A2:2019 + A14:2019; EN 60335-2-69:2012
- 4) Kammerer GmbH | An der B 10 | D-75196 Remchingen

Remchingen, 24.02.2022

Beate Kammerer  
Head of Technical Documentation

## ROKAMAT

Kammerer GmbH  
An der B 10  
75196 Remchingen  
Deutschland



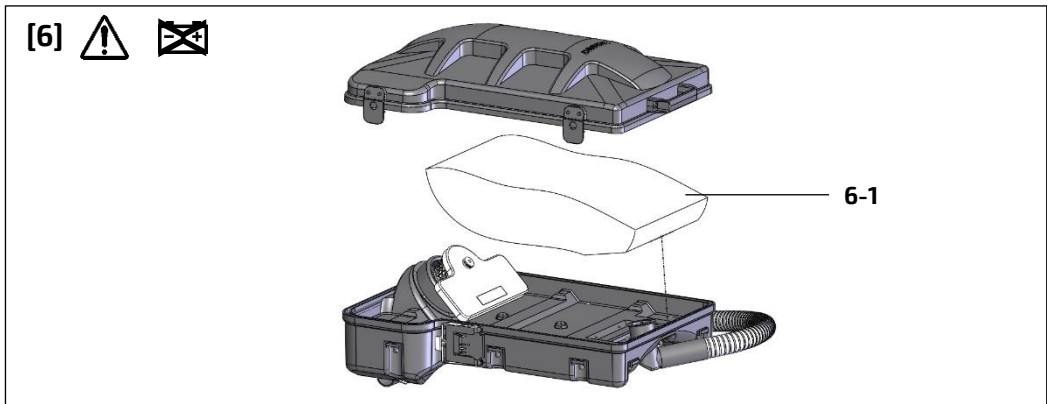
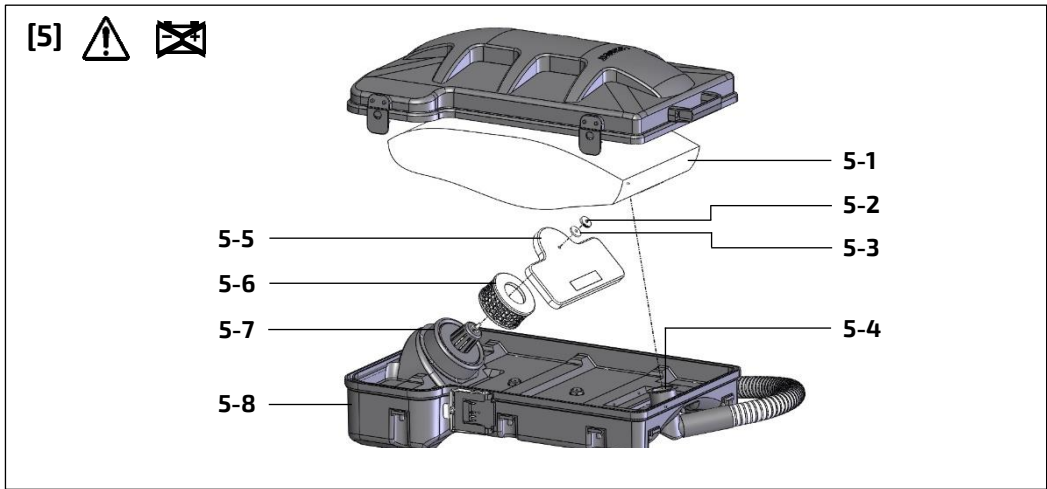
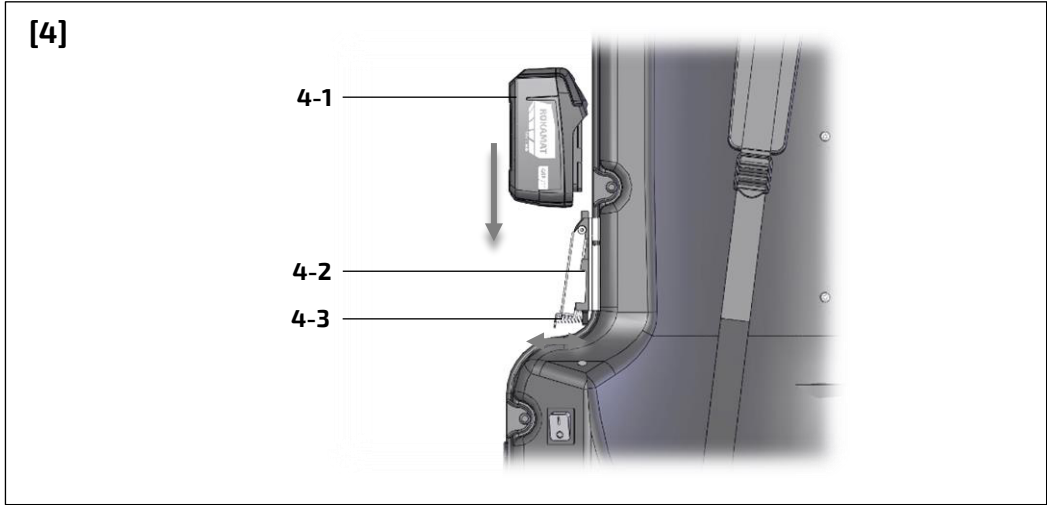
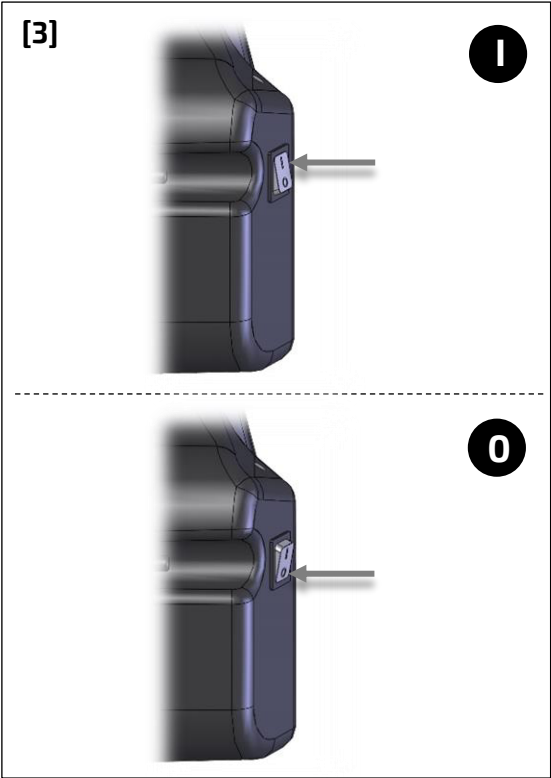
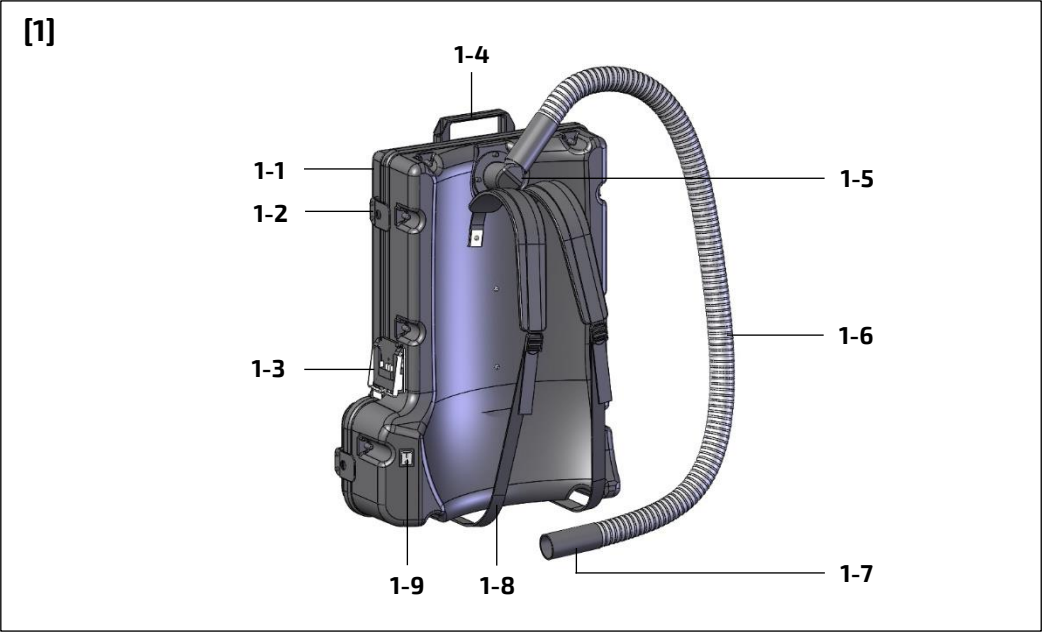

## Contents

1. Symbols .....	3
2. Safety Instructions .....	3
3. Intended Use .....	4
4. Technical Specifications .....	4
5. Device Components .....	4
6. Commissioning .....	4
7. Instructions for Use .....	4
8. Maintenance and Care .....	5
9. Spare Parts and Accessories .....	5
10. Environmental Protection .....	6
11. Declaration of Conformity .....	6
12. Troubleshooting .....	6

## 1. Symbols



For your own protection and for the protection of your power tool, pay attention to all parts of the text that are marked with this symbol!



Risk of electric shock!



Read operating instructions and safety notices! \*)



CAS Li-Ion battery pack \*)



Removing battery pack!



Do not dispose of as domestic waste! \*)



Dust class L \*)



Warning! The device may contain hazardous dust!



Direct Current (DC) \*)



Important advice/information



Confirms the conformity of the power tool with the directives of the European Community. \*)



Confirms the conformity of the power tool with UK legislation. \*)

\*) These symbols are (also) on the device.

## 2. Safety Instructions

### For your safety



#### WARNING!

**Read all safety warnings and instructions.** Failure to follow all safety warnings and instructions may result in electric shock, fire and/or serious injury.



Do not use this power tool before you have thoroughly read and completely understood this Instruction Manual, the enclosed "General Safety Instructions", instructions for battery packs and chargers.

**Keep all safety instructions and information for future reference.** Pass on your power tool only together with these documents.

Please also observe the relevant national industrial safety regulations.

### General safety instructions for dry vacuum cleaners:

**WARNING! The device is only intended for dry cleaning.** Don't use the device outdoors during wet conditions. The device is not suitable for wet cleaning or for extracting wet materials/liquids.

**Risk of asphyxiation!** Keep the carry case out of reach of children. Children may suffocate or be strangled when playing with the carry case.

Only use the device for its proper use. Consider the local conditions and beware of third parties, in particular children, when working with the device.

The device is not intended for use by persons with restricted physical, sensory or mental abilities or those lacking in experience and/or lacking in knowledge. Only people who have been instructed on how to use the device, or have proven their ability to operate it, and have been explicitly instructed to use it, must use the device. Children must not operate the device. Children must be supervised to prevent them from playing with the appliance.

**CAUTION!** Safety devices are provided for your own protection. Never modify or bypass safety device.

Use only identical spare parts for maintenance.

### Battery

**CAUTION!** Only use CAS-compatible batteries with a nominal voltage of 18 V DC.

Recharge only with the charger specified by the manufacturer. A charger that is suitable for one type of battery pack may create a risk of fire when used with another battery pack.

Follow all charging instructions and do not charge the battery pack or tool outside the temperature range specified in the instructions. Charging improperly or at temperatures outside the specified range may damage the battery and increase the risk of fire.

Always install the battery pack fully until the battery locking plate engages. If not, it may accidentally fall out of the tool, causing injury to you or someone around you.

Do not install the battery pack forcibly. If the cartridge does not slide in easily, it is not being inserted correctly.

Rechargeable batteries must be removed from the device before they are charged.

Batteries must be inserted with the correct polarity.

If the device is to be stored unused for a longer period of time, the batteries should be removed.

### Operation

**Risk of explosion! Operation in areas where there is a risk of explosion is prohibited.** Never use the suction device near gasoline, gas, varnish, adhesives or other highly explosive substances. Certain substances can form explosive vapors or mixtures with the suction air due to turbulence and corrode the materials in use on the device.

Never use the device to vacuum up toxic, carcinogenic, flammable, or other hazardous materials such as asbestos, arsenic, barium, beryllium, lead, pesticides, or other materials hazardous to health. Observe the safety data sheets of the processed materials.

Do not attempt to vacuum flammable materials, fireworks, burning cigarettes, hot ashes, hot metal shavings, sharp objects such as razor blades, needles, broken glass, or the like.

Never use the device to vacuum up people or animals.

Observe the safety instructions in the operating instructions.

**CAUTION!** Check the device and the accessories each time before operation, in particular the mains connection and extension cable, to make sure it is

safe and working correctly. Pull out the mains. Plug in case of any damage and do not use the device.

Never leave the device unattended when it is not switched off and with the mains plug.

Do not block cooling vents. These vents permit cooling of the motor. Blockage should be carefully avoided otherwise the motor will burn out from lack of ventilation.

Keep proper footing and balance at all times.

Do not fold, tug or step on the hose.

Stop the cleaner immediately if you notice poor performance or anything abnormal during operation.

**Check damaged parts.** Before further use of the cleaner, a guard or other part that is damaged should be carefully checked to determine that it will operate properly and perform its intended function. Check for alignment of moving parts, binding of moving parts, breakage of parts, mounting, and any other conditions that may affect its operation. A guard or other part that is damaged should be properly repaired or replaced by an authorized service center unless otherwise indicated elsewhere in this instruction manual. Have defective switches replaced by authorized service center. Don't use the cleaner if switch does not turn it on and off.

Do not operate the cleaner while under the influence of drugs or alcohol.

Use extreme caution when cleaning on stairs.

Do not use the cleaner as a stool or work bench. The device may fall down and may result in personal injury.

### Personal protective equipment

**CAUTION!** Wear suitable gloves when working with the device.

Use a dust mask in dusty work conditions.

As a basic rule of safety, use safety goggles or safety glasses with side shields.

### Service

**WARNING! Risk of injury, electric shock!** Always disconnect the mains plug from the socket before performing maintenance work on the device!

**CAUTION! Risk of damage to the device!** Do not clean the device with a hose or high-pressure water jet. Do not attempt to clean the exterior or interior with benzine, thinner or cleaning chemicals. Cracks and discoloration may be caused.

Check the plug and the cable regularly and should either become damaged, in order to avoid a hazard, have them replaced by an authorized customer service center.

**Risk of damage to the device!** Never insert the lamellar filter when wet.

Device with dust class L

The dusts have occupational exposure limits (OEL) of < 1 mg/m³. The filter material must be tested for this vacuum cleaner. The maximum permeability is less than 1 %. There are no special disposal regulations.

**WARNING!** The vacuum cleaner is not approved for dust class M or H. Corresponding materials must therefore not be vacuumed!

**Do not operate the device without the complete filtration system. Replace a damaged filter immediately.**

Only trained personnel are permitted to use the device and the substances for which it is to be used, including the safe procedure for disposing of the vacuumed material.

An air exchange rate L must be present in the room when the exhaust gas is returned into the room. To remain within the required limit values, the volume flow of returned air must be no greater than 50 % of the fresh air volume (room volume V<sub>R</sub> x air exchange rate L<sub>W</sub>). Without special ventilation measures, the following applies: L<sub>W</sub> = 1h<sup>-1</sup>.

Please also observe the relevant national industrial regulations.

This device contains dust that is harmful to your health. Emptying and maintenance, including removal of the dust bag, may only be performed by technical specialists wearing suitable personal protective equipment. Observe the applicable safety instructions for the materials being handled.

For servicing performed by the user, the device must be disassembled, cleaned and maintained only to the degree that this is possible without presenting a danger to the maintenance personnel and other persons. Suitable precautionary measures include detoxification before disassembly. Make provisions for local forced ventilation at the location where the device is to be disassembled, for cleaning the maintenance surface and to ensure adequate protection for the personnel.

All contaminated objects resulting from maintenance and repair work that cannot be satisfactorily cleaned must be correctly disposed of. Such objects

must be disposed of in sealed bags in accordance with the applicable regulations for the disposal of this type of waste.

Emission levels

**NOTE!** Values for the A-weighted sound pressure level and for the total vibration values can be found in the "Technical specifications" table in chapter 4.

The vibration emission level given in this information sheet has been measured in accordance with a standardized test and may be used to compare one tool with another. It may be used for a preliminary assessment of exposure.

3. Intended Use

The battery-operated rucksack vacuum cleaner RVC-L is intended for vacuuming dry and non-flammable dusts indoors and outdoors and as a dust extractor in combination with a dust generating machine. The RVC-L C is suitable for the collection of dust of dust class L, which is harmful to health. This device is suitable for commercial use, e. g. in construction sites. The usage height of the backpack vacuum cleaner is limited to 2,000 m.

Only sufficiently qualified and trained personnel is allowed to work with the vacuum cleaner. The intended use includes the observance of the operating instructions, in particular the safety instructions and the observance of generally recognized accident prevention regulations.

4. Technical Specifications

Battery-operated rucksack vacuum cleaner <b>RVC-L C</b> <b>Item no. 12000</b>	
Voltage of battery pack	18 V DC
Negative pressure	138 hPa
Air flow	108 m³/h
Filter bag capacity	15 l
Total weight	6,1 kg
Dimension compact (LxHxW)	630x430x200 mm
Dust class	L
<b>A-weighted sound pressure level</b> (see cap. 2 "Emission levels"):	
Sound pressure level L <sub>pA</sub>	71 dB(A)
Uncertainty K <sub>pA</sub>	2,5 dB

**Total vibration value** (see cap. 2 "Emission levels"):

Emission value a <sub>h</sub>	<2,5 m/s²
Uncertainty K	1,5 m/s²

5. Device Components

The specified illustrations can be found in fig. [1] on page 2 of the operating instructions.

- 1-1 Upper part
- 1-2 Clamp
- 1-3 Battery fixing
- 1-4 Handle
- 1-5 Flange with elbow fitting
- 1-6 Suction hose
- 1-7 Socket pipe
- 1-8 Belt
- 1-9 Switch

6. Commissioning

**CAUTION!**

**Before switching on the power tool:** Unpack rucksack vacuum cleaner and accessories and check that no parts are missing or damaged.

**Always use the vacuum cleaner with the filters (lamellar filter and filter bag) properly installed!** Do not use a damaged filter bag. Otherwise the vacuumed dust or particles may be exhausted from the cleaner and they may cause respiratory disease to the operator.

Adjusting the shoulder belt [2]

Put the device on its back and then adjust it to the body by pulling on the centre straps. Do not put on too tight.

Switching the device on and off [3]

**Switching on:** Set switch [1-9] to position I.  
**Switching off:** Set switch [1-9] to position 0.

7. Instructions for Use

**WARNING!**

**Risk of injury, electric shock!**  
Always remove the battery pack before performing any type of work on the machine!

**CAUTION!**

**Risk of damage to the device!**  
Do not place the device on the floor during operation! Only carry it on your back.

**Danger due to technical defect!**  
Switch off the motor immediately if the vacuuming performance decreases.

Connecting the tool

Push the socket pipe [1-7] onto the intake socket of the corresponding tool. Check for correct fit!

**ADVICE!**

The socket pipe is suitable for Ø40mm intake sockets. For smaller diameters, use the appropriate adapter.

Installing or removing battery pack [4]

**CAUTION!**

**Risk of damage to the device! Risk of injury!**  
Only use CAS-compatible batteries with a nominal voltage of 18 V DC!

Always switch off the tool before attaching or removing the battery.

Hold the tool and battery securely when attaching or removing the battery. If you do not hold the tool and the battery securely, they can slip out of your hand, which can damage the tool and the battery and cause personal injury.

Installing

To install the battery [4-1], align the tongue on the battery pack with the groove in the battery fixing [4-2] and slip it into place. Insert it all the way until it locks in the battery locking plate [4-3].

Removing

To remove the battery pack [4-1], pull it from the battery fixing [4-2] while pressing the battery locking plate [4-3] down.

Handle [1]

Always use the handle [1-4] to transport the suction unit main part.

## 8. Maintenance and Care

### WARNING!

#### Risk of injury!

Always be sure that the tool is switched off and the battery pack is removed before performing maintenance work on the machine!

### CAUTION!

#### Risk of damage to the device!

Do not clean the device with a hose or high-pressure water jet.  
Never use gasoline, benzine, thinner, alcohol or the like. Discoloration, deformation or cracks may result.

Check all wearing parts once a month.

- Repairs may be carried out by an authorized customer service center only.
- Repairs to electrical tools must be carried out by qualified electricians only!
- Pay attention to the safety inspection for mobile devices for industrial use in accordance with the locally applicable regulations.

Clean the device and accessories after use with clean with a damp cloth.

During the warranty period do not loosen the screws on the housing. Non-compliance will deem the guarantee obligations of the manufacturer null and void.

At least once a year, the manufacturer or an instructed person must perform a technical inspection including filters, air tightness of the vacuum cleaner, and control mechanisms.

### Paper filter bags [5]

### ADVICE!

When the paper filter bag [5-1] is already full, replace with *new* one. Continuous use with the paper filter bag full results in reduced suction power.

### Replacement

- Remove the upper part [1-1] by lifting the clamps [1-2].
- Pull off the paper filter bag [5-1] from the flange [5-4] at the reinforced point.

- Fit a new paper filter bag [5-1] onto the flange [5-4]. Check for correct fit/tightness!!
- Replace the upper part [1-1] and engage the clamps [1-2]. Make sure that the paper filter bag [5-1] is not jammed anywhere.

### Fabric filter bag [6]

### CAUTION!

#### Risk of damage to the device!

The *fabric filter bag* is an *optional* accessory and *only suitable for polystyrene!*

### ADVICE!

When the paper filter bag [6-1] is already full, replace with *new* one. Continuous use with the paper filter bag full results in reduced suction power.

### Emptying

The fabric filter bag is equipped with a **zipper**. When this is opened, the contents can be emptied. Then close the zipper again.

### Replacement

- Remove the upper part [1-1] by lifting the clamps [1-2].
- Pull the fabric filter bag [6-1] off the flange [5-4] at the fabric filter attachment in the direction of the handle.
- Push on new fabric filter bag [6-1] parallel to the flange [5-4]. Check correct fit/tightness!
- Replace the upper part [1-1] and engage the clamps [1-2]. Make sure that the fabric filter bag [5-1] is not jammed anywhere.

### Lamellar filter [5]

### CAUTION!

#### Risk of damage to the device!

Never insert the lamellar filter when wet.

### ADVICE!

To keep optimum suction power and clean exhaust, clean the lamellar filter [5-6] periodically. If enough suction power is not obtained even after the cleaning, replace the filter with new one.

### Cleaning

If necessary, remove the lamellar filter (see "Replacement"), clean it under running water and dry.

### Replacement

- Remove the upper part [1-1] by lifting the clamps [1-2].
- Loosen the knurled nut [5-2] and remove it together with the rubber washer [5-3] and the covering for lamellar filter [5-5].
- Remove the lamellar filter [5-6] from the motor cap [5-7].

Insert the *new* lamellar filter in reverse order.

### Remove dust from the motor regularly

It is possible that particles deposit inside the device during operation. This impairs the cooling of the device. Conductive build-up can impair the protective insulation of the power tool and cause electrical hazards.

The vacuum unit should be cleaned regularly, often and thoroughly through all of the motor hood [5-7] and the vacuum cleaner base [5-8] using a vacuum cleaner or by blowing in dry air. Prior to this operation, separate the power tool from the power source and wear protective glasses and dust mask.

### Environmental conditions

#### Operation

Temperature range: +5° C to +50° C  
Humidity: ≤ 85 %, non-condensing  
Climate: dry

#### Transport and storage

Temperature range: -5° C to +55° C  
Humidity: 0 % to 70 %  
Climate: dry, roofed, dew protected

## 9. Spare Parts and Accessories

Accessories can be found in the manufacturer's catalogues. Exploded drawings and spare-part lists can be found on our homepage: [www.roka-mat.com](http://www.roka-mat.com).

**Use only original ROKAMAT spare parts and accessories!**

## 10. Environmental Protection

The vacuumed dust may contain harmful substances. Dispose appropriately.

**Observe national regulations on environmentally compatible disposal and on the recycling of disused machines, packaging and accessories.**



Li-Ion

**For Great Britain and EU countries:** Do not dispose of electric equipment or battery pack together with household waste material! In observance of the European Directives, on Waste Electric and Electronic Equipment and Batteries and Accumulators and their implementation in accordance with national laws, electric equipment and batteries and battery pack(s) that have reached the end of their life must be collected separately and returned to an environmentally compatible recycling facility.

### ADVICE!

Über Entsorgungsmöglichkeiten beim Fachhändler informieren!

## 11. Declaration of Conformity

It is expressly declared that the rucksack vacuum cleaner and dust extractor listed on the first page under 1) from the serial number indicated onwards complies with all relevant provisions of the directives or regulations listed in 2) and that the harmonized standards listed in 3) have been applied. The technical documentation is available from the authorized documentation agent named in 4).

## 12. Troubleshooting

Problem	Possible causes	Remedy
No, insufficient or decreasing extraction power.	Suction tube, suction hose or suction nozzle blocked.	Remove blockages from suction tube, suction hose or suction nozzle.
	Suction hose kinked.	Remove kinks.
	Suction hose defective.	Replace defective suction hose.
	Speed at the connected tool too high.	Reduce speed at connected tool.
	Paper filter bag/fabric filter bag* full.	Replace paper filter bag or empty fabric filter bag*.
	Lamellar filter blocked.	Clean or replace lamellar filter.
	Upper part opened.	Close upper part correctly.
Motor power fluctuates.	Carbon brushes worn.	Replace carbon brushes.
RVC-L C not working.	No battery inserted.	Insert battery.
	Battery discharged.	Charge battery.
	The restart protection is active.	Switch the vacuum cleaner off and on again.
Dust leakage during vacuuming.	Paper filter bag or fabric filter bag* defective.	Replace defective paper filter bag or fabric filter bag*.
	Paper filter bag/fabric filter bag* inserted incorrectly.	Check the fit of the paper filter bag/fabric filter bag*.
	Upper part opened.	Close the upper part correctly.

\* Special accessories

If problems other than those listed occur, please contact your ROKAMAT service workshop or your local specialist dealer.